



Tradewind VA



Flight Briefing Package

TCC910C KSFO-KBOS

22-Sep-2018 #2

RELEASE #2

SAN FRANCISCO INTL
(UNITED STATES)

-

LOGAN INTL
(UNITED STATES)

PREPARED BY CHRISTIAN BREUER (TCA2984)

CHRISTIAN@TCA-CHARTER.DE

22 SEP 1001 UTC

Fuel Planning (kg)	EU-OPS	Fuel	Time
TRIP		25.778	04:32
CONT 5%		1.289	00:15
HOLD	KBOS	1.732	00:20
ALTN	KEWR	4.885	00:41
FINAL RESV		2.598	00:30
ADD FUEL		441	00:05
MIN T/O		36.723	06:22
EXTRA		1.299	00:15
TAXI		780	00:15
RELEASE	KSFO	38.802	06:52
ARR FUEL	KBOS	11.620	01:54

Load Planning (kg)	PJTGE	Plan	Limit
Empty Weight		156.146	
Payload		0	
Zero Fuel Weight	Limit	156.146	209.106
Fuel		38.802	162.613
Ramp Weight		194.948	348.359
Take-Off Weight KSFO		194.168	273.117
Landing Weight KBOS		168.390	223.167
Underload		52.960	Lim ZFW
Max Extra Fuel		54.777	Lim LDW

Cost Planning		
Flight Time	04:32\$	25.756
Fuel	27.182\$	22.060
Total	\$	47.816

TRADEWIND CARIBBEAN FLIGHTPLAN - IFR TCC910C PJTGE KSFO-KBOS

ALL WEIGHTS IN KILOGRAMS (KG) STD 22SEP/1155Z

OPF 2 - PREPARED 22SEP/1001Z BY CHRISTIAN BREUER (TCA2984) CHRISTIAN@TCA-CHARTER.DE

TR910C/TCC910C PJTGE/B777-2LR GE SEL/EGAP ROUTE: KSFOKBOS02

DEP: KSFO/SFO 01R ELEV 13 FT COST INDEX: 250 TTL G/C DIST: 2347 NM
 ARR: KBOS/BOS 22R ELEV 19 FT INIT ALT: FL410 TTL F/P DIST: 2384 NM
 FUEL BIAS: 100.5% TTL AIR DIST: 2098 NM
 AVG WIND CMP: TL063 KT

ALT: KEWR/EWR 22R ELEV 17 FT 213 NM

CONFIG	DOW	PAX	CARGO	TOTAL	ULOAD LIM	ZFW	TOW	LDW
STANDARD	156146	0	0	0	52960 ZFW	MAX 209106	273117	223167
						PLN 156146	194168	168390
						ACT

** TAKE-OFF DATA KSFO 01R **

COND: 194168 KG // RWY DRY // +11°C Q1016 290/10 // LMT: OBS(A)
 CONFIG: FLAPS 5 // D-T01 +64C // A/I OFF/AUTO // A/C ON
 SPEEDS: V1=132 VR=134 V2=141
 ENG OUT: AT 4 DME 'SFO' 115.8 LT HDG 285 TO JOIN 'OAK' 116.8 255 RADIAL.

	FUEL	CORR	ENDUR	
TRIP	25778	04:32	
CONT 5%	1289	00:15	
ALTN KEWR	4885	00:41	
FINAL RESV	2598	00:30	
HOLD	1732	00:20	
ADD FUEL	441	00:05	
MIN T/O	36723	06:22
EXTRA	1299	00:15	CAPTAINS SIGNATURE (....)
TAXI	780	00:15	
RELEASE	38802	06:52	I ACCEPT THIS OPF AND I AM FAMILIAR
ARR FUEL	11620	01:54	WITH THE PLANNED ROUTE AND AERODROMES

FUEL TANK CAP 162613 KG / MAX EXTRA FUEL 56076 KG LIM BY LDW
 TRIP CORR FOR 5000 KG TOW INCR: +581 KG / 5000 KG TOW DECR: -457 KG
 2000 FT LOWER: +513 KG / EET 04:32 CLB: 250/310/84 DES: 84/320/250

KSFO STD 11:55Z/04:55L ETD 11:55Z ACT OFBL EST T/O 12:10Z ACT T/O
 KBOS STA 17:30Z/13:30L ETA 16:54Z ACT ONBL EST LDG 16:42Z ACT LDG
 SKD 05:35 PLN 04:59 TTL BLCK EST FLT 04:32 TTL FLT

ATC ROUTE: N0480F410 TRUKN2 TIPRE Q126 INSLO DCT DTA J84 OBK J547 PMM J70 JHW
 Q82 PONCT JFUND2

ALTERNATE PLANNING

ALTN/RWY DIST ALT/FL MSA COMP TIME FUEL DIFF ROUTE
 KEWR/22R 213 16000 065 HD029 00:41 4885 - BOSOX V1 HFD V3 CMK V623 SAX

MOST CRITICAL MORA 16600 FT AT FROGS

AWY	WAYPOINT	MT	ALT	MSA	FREQ	TAS	LEG	FUEL	REM / USED	LEG	ACC
-FIR	NAME		ISA	WND/SPD	GS	REM	POSITION	ETD / ATO			

	KSFO/01R		13	061				38.0 / 0.8		
	SAN FRANCISCO INTL				2384	N3736.0	W12223.8/.....		
TRUKN2	TYDYE	033	*CLB	061	7			36.9 / 1.9	03	00.03
			P12	223/009	2377	N3741.0	W12216.1/.....		
TRUKN2	TRUKN	043	*CLB	061	3			36.7 / 2.1	00	00.03
			P11	225/012	2374	N3743.0	W12213.8/.....		
TRUKN2	COSMC	043	*CLB	061	12			36.1 / 2.7	02	00.05
			P11	227/023	2362	N3750.0	W12200.2/.....		
TRUKN2	TIPRE	050	*CLB	066	51			34.5 / 4.3	06	00.11
			P03	242/041	2311	N3812.0	W12102.1/.....		
Q126	*TOC	066	FL410	127	480	24		34.1 / 4.7	03	00.14
			M04	244/048	526	2286	N3817.0	W12032.5/.....	
Q126	INSLO	066	FL410	148	481	154		32.4 / 6.4	17	00.31
-KZLC			M04	249/044	524	2132	N3841.0	W11718.8/.....	
DCT	DTA	066	FL410	153	116.10	481	227	30.0 / 8.8	26	00.57
	DELTA		M04	259/044	526	1905	N3918.0	W11230.3/.....	
DCT	*BDRY	065	FL410	142	481	131		28.6 / 10.2	15	01.12
-KZDV			M04	268/044	526	1774	N3947.0	W10945.8/.....	
J84	EKR	067	FL410	147	115.20	481	86	27.7 / 11.1	10	01.22
	MEEKER		M04	270/045	526	1689	N4004.0	W10755.4/.....	
J84	FROGS	063	FL410	166	481	97		26.7 / 12.1	11	01.33
			M04	270/047	526	1592	N4031.0	W10554.6/.....	
J84	SNY	065	FL410	166	115.90	482	137	25.3 / 13.5	16	01.49
	SIDNEY		M04	271/049	529	1455	N4106.0	W10259.9/.....	
J84	ELJAY	077	FL410	069	482	80		24.5 / 14.3	09	01.58
			M04	269/050	531	1375	N4114.0	W10113.2/.....	
J84	*BDRY	079	FL410	057	482	99		23.5 / 15.3	11	02.09
-KZMP			M04	269/053	535	1275	N4121.0	W09902.7/.....	
J84	OBH	082	FL410	045	114.80	482	31	23.2 / 15.6	03	02.12
	WOLBACH		M04	269/054	536	1245	N4123.0	W09821.2/.....	
J84	TODDO	073	FL410	049	482	137		21.8 / 17.0	16	02.28
			M04	266/060	541	1107	N4151.0	W09522.5/.....	
J84	JORDY	077	FL410	040	482	83		21.0 / 17.8	09	02.37
			M03	264/065	545	1024	N4205.0	W09332.5/.....	
J84	*BDRY	080	FL410	029	482	11		20.9 / 17.9	01	02.38
-KZAU			M03	263/066	546	1013	N4207.0	W09316.4/.....	
J84	CAPPR	080	FL410	036	482	38		20.5 / 18.3	04	02.42
			M03	263/069	549	975	N4213.0	W09226.6/.....	
J84	DBQ	081	FL410	041	115.80	482	77	19.8 / 19.0	09	02.51
	DUBUQUE		M03	261/075	556	897	N4224.0	W09043.5/.....	
J84	COTON	096	FL410	037	482	62		19.2 / 19.6	06	02.57
			M03	259/080	559	835	N4219.0	W08919.7/.....	
J84	OBK	098	FL410	037	113.00	482	61	18.6 / 20.2	07	03.04
	NORTHBROOK		M03	258/087	564	774	N4213.0	W08757.0/.....	

J547	KUBBS	083	FL410	027	482	25	18.4 / 20.4	02	03.06
					M03 258/089 569	750	N4218.0 W08724.1/.....	
J547	PMM	084	FL410	027	112.10	481	17.8 / 21.0	07	03.13
	PULLMAN				M03 259/093 573	691	N4228.0 W08606.2/.....	
J547	*BDRY	096	FL410	031	481	49	17.4 / 21.4	05	03.18
	-KZOB				M03 259/097 575	642	N4227.0 W08500.0/.....	
J70	ALPHE	098	FL410	032	481	22	17.2 / 21.6	02	03.20
					M03 259/098 576	620	N4226.0 W08431.5/.....	
J70	DUNKS	098	FL410	032	481	14	17.1 / 21.7	01	03.21
					M03 259/098 577	606	N4226.0 W08412.6/.....	
J70	SVM	099	FL410	032	114.30	481	16.8 / 22.0	03	03.24
	SALEM				M03 259/099 577	580	N4225.0 W08336.6/.....	
J70	*BDRY	099	FL410	032	481	35	16.5 / 22.3	04	03.28
	-CZYZ				M03 260/101 579	545	N4223.0 W08248.2/.....	
J70	DAFLU	101	FL410	028	481	4	16.5 / 22.3	00	03.28
					M03 260/100 579	540	N4223.0 W08242.3/.....	
J70	BROKK	101	FL410	031	481	50	16.0 / 22.8	05	03.33
	-KZOB				M03 260/102 580	490	N4220.0 W08135.9/.....	
J70	BEWEL	102	FL410	033	481	37	15.7 / 23.1	04	03.37
					M03 260/102 580	453	N4217.0 W08045.7/.....	
J70	JHW	103	FL410	040	114.70	481	15.0 / 23.8	08	03.45
	JAMESTOWN				M03 258/103 580	380	N4211.0 W07907.2/.....	
Q82	WAYLA	090	FL410	050	481	59	14.5 / 24.3	06	03.51
					M03 258/106 586	321	N4221.0 W07749.9/.....	
Q82	VIEEW	092	FL410	049	481	35	14.2 / 24.6	04	03.55
					M03 258/107 588	286	N4226.0 W07702.5/.....	
Q82	*BDRY	093	FL410	049	481	3	14.2 / 24.6	00	03.55
	-KZWY				M03 258/107 588	283	N4227.0 W07657.2/.....	
Q82	TYROD	093	FL410	048	481	8	14.1 / 24.7	01	03.56
	-KZNY				M03 258/107 588	275	N4228.0 W07646.3/.....	
Q82	*BDRY	094	FL410	048	481	11	14.0 / 24.8	01	03.57
	-KZBW				M03 258/107 588	264	N4230.0 W07632.6/.....	
Q82	MEMMS	094	FL410	048	481	10	13.9 / 24.9	01	03.58
	-KZNY				M03 258/107 588	254	N4231.0 W07618.2/.....	
Q82	LOXXE	094	FL410	048	481	26	13.7 / 25.1	02	04.00
	-KZBW				M03 258/107 588	228	N4234.0 W07544.5/.....	
Q82	*TOD	095	*DES	063		83	13.0 / 25.8	09	04.09
					M03 258/107	145	N4245.0 W07352.7/.....	
Q82	PONCT	097	*DES	061		2	13.0 / 25.8	00	04.09
					M02 258/110	143	N4245.0 W07349.8/.....	
JFUND2	STOLI	104	*DES	061		31	12.9 / 25.9	04	04.13
					P10 257/102	112	N4244.0 W07307.8/.....	
JFUND2	MNSTA	113	*DES	061		22	12.9 / 25.9	02	04.15
					P09 266/077	90	N4241.0 W07238.8/.....	

JFUND2	SEETS	114	*DES 061	14	12.9 / 26.0	02	04.17
			P10 270/070	76	N4239.0 W07219.0/.....	
JFUND2	*BDRY	113	*DES 061	4	12.8 / 26.0	01	04.18
			P10 271/068	72	N4238.0 W07213.3/.....	
JFUND2	DUBLE	113	*DES 061	8	12.8 / 26.0	01	04.19
			P09 273/060	64	N4237.0 W07203.5/.....	
JFUND2	BASEZ	114	*DES 061	9	12.8 / 26.1	01	04.20
			P08 274/053	55	N4235.0 W07151.6/.....	
JFUND2	JFUND	114	*DES 049	1	12.8 / 26.1	00	04.20
			P08 274/052	54	N4235.0 W07149.2/.....	
JFUND2	AUTUM	117	*DES 049	10	12.7 / 26.1	02	04.22
			P08 276/045	44	N4233.0 W07136.5/.....	
JFUND2	WINTA	120	*DES 049	10	12.7 / 26.2	02	04.24
			P07 278/039	33	N4230.0 W07122.9/.....	
JFUND2	HRRIS	120	*DES 049	10	12.6 / 26.3	02	04.26
			P05 284/033	23	N4228.0 W07109.3/.....	
JFUND2	ISLAY	078	*DES 049	5	12.6 / 26.3	01	04.27
			P04 289/031	19	N4230.0 W07104.6/.....	
JFUND2	LWLND	035	*DES 049	6	12.6 / 26.4	01	04.28
			P02 297/028	13	N4235.0 W07101.1/.....	
JFUND2	KBOS/22R	192	19 049	13	12.2 / 26.6	04	04.32
	LOGAN INTL				N4223.0 W07100.3/.....	

WIND INFORMATION - OBS 22/SEP 00:00

(CLIMB) **INSLO** **DTA** **EKR**
FL400 243/047 -60 FL450 252/053 -64 FL450 258/053 -64 FL450 262/056 -63
FL320 243/036 -43 FL430 251/050 -62 FL430 259/050 -62 FL430 265/052 -62
FL240 229/033 -23 FL410 250/045 -61 FL410 260/045 -61 FL410 270/046 -61
16000 225/021 -6 FL390 248/039 -59 FL390 261/039 -59 FL390 277/040 -59
8000 209/012 +11 FL370 245/036 -55 FL370 261/037 -55 FL370 276/036 -55

SNY **OBH** **TODDO** **CAPPR**
FL450 264/057 -62 FL450 264/063 -62 FL450 263/068 -63 FL450 262/075 -62
FL430 267/054 -61 FL430 266/060 -61 FL430 264/065 -61 FL430 262/073 -61
FL410 271/049 -61 FL410 269/054 -60 FL410 266/060 -60 FL410 263/069 -60
FL390 277/045 -60 FL390 274/049 -59 FL390 269/055 -59 FL390 264/065 -58
FL370 278/042 -56 FL370 277/045 -56 FL370 273/051 -55 FL370 268/061 -55

COTON **PMM** **SVM** **BEWEL**
FL450 261/083 -63 FL450 264/090 -63 FL450 264/090 -62 FL450 260/088 -62
FL430 260/083 -61 FL430 262/092 -61 FL430 262/095 -61 FL430 260/095 -61
FL410 260/081 -59 FL410 259/093 -59 FL410 260/100 -59 FL410 260/102 -59
FL390 259/079 -57 FL390 256/095 -57 FL390 257/105 -58 FL390 260/111 -58
FL370 260/074 -54 FL370 256/092 -54 FL370 256/102 -54 FL370 259/108 -54

WAYLA **(DESCENT)**
FL450 258/094 -63 FL400 258/098 -57
FL430 258/100 -61 FL320 256/107 -38
FL410 258/106 -60 FL240 262/085 -23
FL390 259/113 -58 16000 274/068 -7
FL370 257/112 -53 8000 297/042 +3

END FLIGHTPLAN 02540 TCC910C PJTGE KSFO-KBOS 22SEP2018

[ATC FLIGHTPLAN]

(FPL-TCC910C-IS
-B77L/H-SDE1FGHIJ1J5M1RWXY/LB2
-KSF01155
-N0480F410 TRUKN2 TIPRE Q126 INSLO DCT DTA J84 OBK J547 PMM J70
JHW Q82 PONCT JFUND2
-KBOS0432 KEWR
-PBN/A1B1C1D1L101S2 NAV/RNVD1E2A1 DOF/180922 REG/PJTGE
EET/KZLC0031 KZDV0112 KZMP0209 KZAU0238 KZOB0318 CZYZ0328
KZOB0337 KZWY0355 KZBW0357
SEL/EGAP CODE/484DC7 RVR/75 OPR/TRADEWIND CHARTER
ORGN/TNCCTCAP PER/C
RMK/TCAS
-E/0637)

[PLANNING WEATHER]

ORIGIN: KSFO/SFO (SAN FRANCISCO INTL, UNITED STATES)

UTC -07:00

KSFO 220856Z 29010KT 10SM FEW002 11/11 A2999 RMK AO2 SLP154 T01110106
58001

KSFO 220901Z 2209/2312 29009KT P6SM FEW010
FM221200 VRB04KT P6SM FEW010
FM222100 29016KT P6SM SKC
FM230400 29010KT P6SM FEW010
FM231000 29008KT P6SM SCT010

DESTINATION: KBOS/BOS (LOGAN INTL, UNITED STATES)

UTC -04:00

KBOS 220854Z 22014KT 10SM FEW060 SCT085 BKN110 21/19 A2984 RMK AO2
RAB26E35 SLP105 P0000 60003 T02110189 55008

KBOS 220938Z 2210/2312 23015KT P6SM FEW060 BKN100
FM221200 27014G22KT P6SM FEW250
FM221400 30014G20KT P6SM SCT250
FM221600 33013KT P6SM SCT250
FM222100 36007KT P6SM SCT200

ALTERNATE: KEWR/EWR (NEWARK LIBERTY INTL, UNITED STATES)

UTC -04:00

KEWR 220851Z 23007KT 10SM FEW025 SCT060 BKN110 BKN180 22/21 A2995 RMK AO2
SLP142 60000 T02220206 53002

KEWR 220852Z 2209/2312 24009KT P6SM FEW025 SCT035 BKN120
FM221100 30011KT P6SM SCT035 BKN050
FM221300 34013G20KT P6SM FEW035 SCT200
FM221600 34011G18KT P6SM FEW050 BKN150
FM222000 35009KT P6SM FEW050 BKN150
FM230100 03006KT P6SM FEW050 BKN120
FM230400 03004KT P6SM BKN200

KSLC/SLC (SALT LAKE CITY INTL, UNITED STATES)

UTC -06:00

KSLC 220854Z 16011KT 10SM CLR 17/M02 A3010 RMK AO2 SLP144 T01721022 56004

KSLC 220942Z 2210/2312 15006KT P6SM SKC
FM221600 16016G23KT P6SM SKC
FM222100 29004KT P6SM SKC
FM230300 15011KT P6SM SKC

KDEN/DEN (DENVER INTL, UNITED STATES)

UTC -06:00

KDEN 220853Z 23010KT 10SM CLR 13/06 A3021 RMK AO2 SLP162 T01280056 56007

KDEN 220853Z 2209/2312 21011KT P6SM SKC
FM221500 25006KT P6SM SKC
FM221800 VRB05KT P6SM SKC
FM222000 10009KT P6SM FEW150
FM230100 13010KT P6SM FEW150
FM230300 16011KT P6SM SKC
FM230600 20011KT P6SM FEW250

KLNK/LNK (LINCOLN, UNITED STATES)**UTC -05:00**

KLNK 220854Z AUTO 36004KT 10SM CLR 06/05 A3033 RMK A02 SLP272 T00610050
58004

KLNK 220520Z 2206/2306 VRB04KT P6SM SKC
FM221400 16007KT P6SM SKC
FM221800 18011KT P6SM SKC
FM230100 15006KT P6SM SKC

KORD/ORD (OHARE INTL, UNITED STATES)**UTC -05:00**

KORD 220851Z 35011KT 10SM FEW031 BKN040 OVC250 12/06 A3028 RMK A02 SLP253
T01170061 50003

KORD 220906Z 2209/2312 35010KT P6SM BKN035 BKN250
FM221300 08010KT P6SM SCT035
TEMPO 2213/2216 BKN030
FM230100 VRB03KT P6SM SKC

KCLE/CLE (CLEVELAND-HOPKINS INTL, UNITED STATES)**UTC -04:00**

KCLE 220851Z 35012KT 10SM BKN031 OVC042 17/09 A3023 RMK A02 SLP231
T01670094 53019 \$

KCLE 220852Z 2209/2312 02010KT P6SM BKN035
FM221400 03009KT P6SM BKN025
FM222100 03006KT P6SM SCT035
FM230000 06005KT P6SM SCT250

KBUF/BUF (BUFFALO NIAGARA INTL, UNITED STATES)**UTC -04:00**

KBUF 220854Z 30007KT 10SM BKN034 13/07 A3016 RMK A02 SLP210 T01280072
51029 \$

KBUF 220848Z 2209/2306 32009KT P6SM OVC030
FM221200 36010KT P6SM BKN030
FM221800 03006KT P6SM BKN035
FM222000 VRB03KT P6SM SCT050
FM222200 00000KT P6SM SCT250

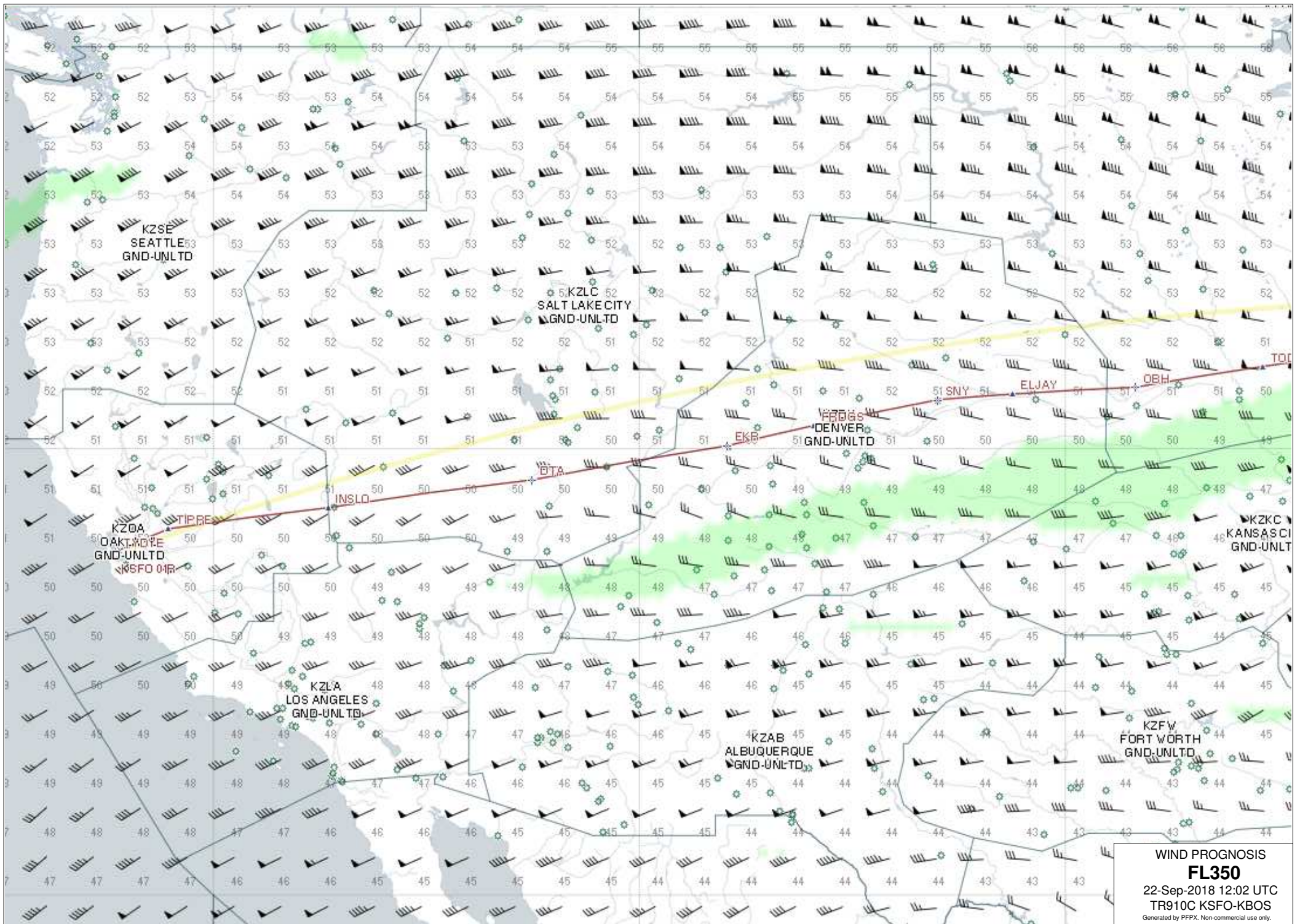

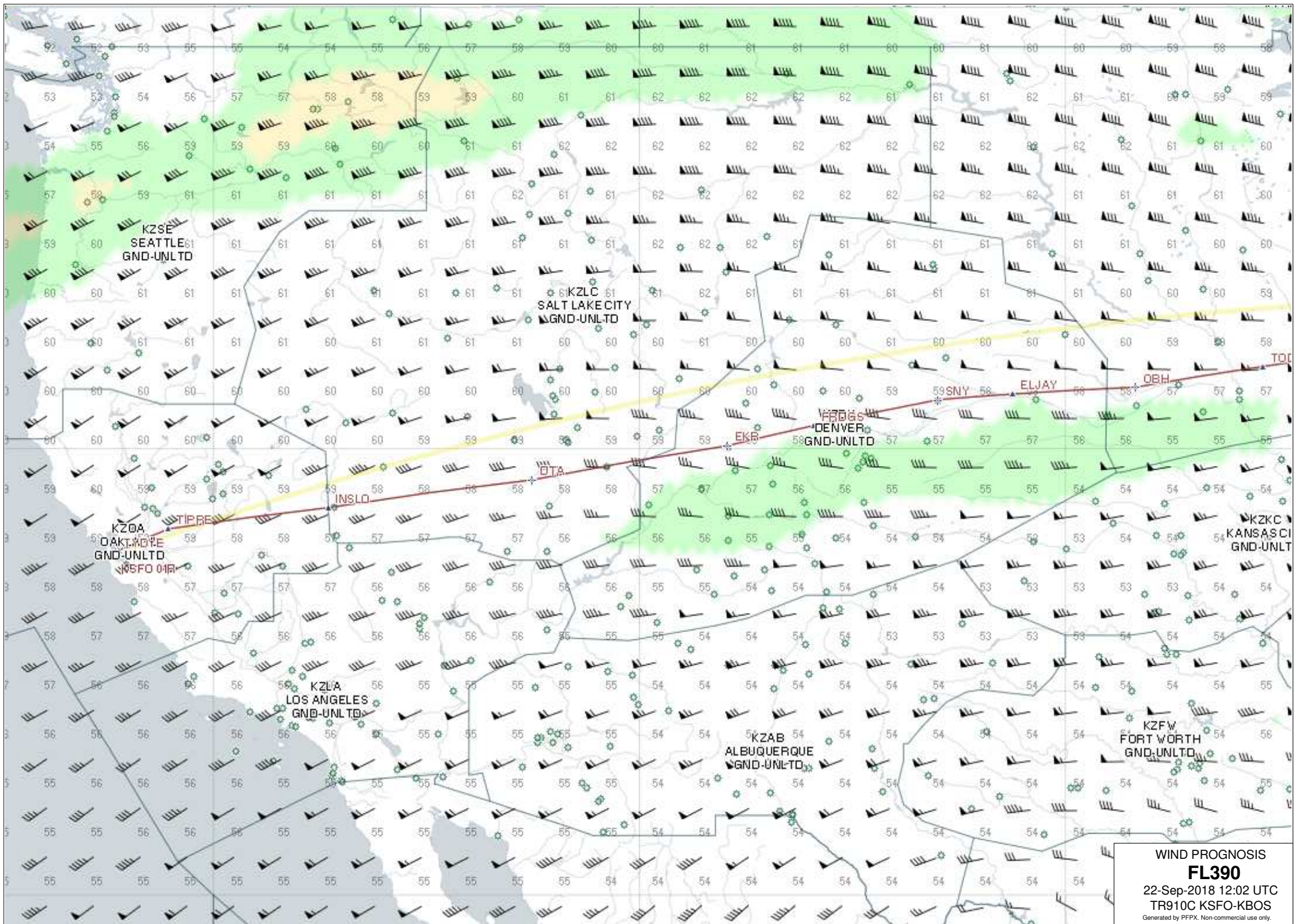

WIND PROGNOSIS

FL390

22-Sep-2018 12:02 UTC

TR910C KSFO-KBOS

Generated by PFPX. Non-commercial use only.

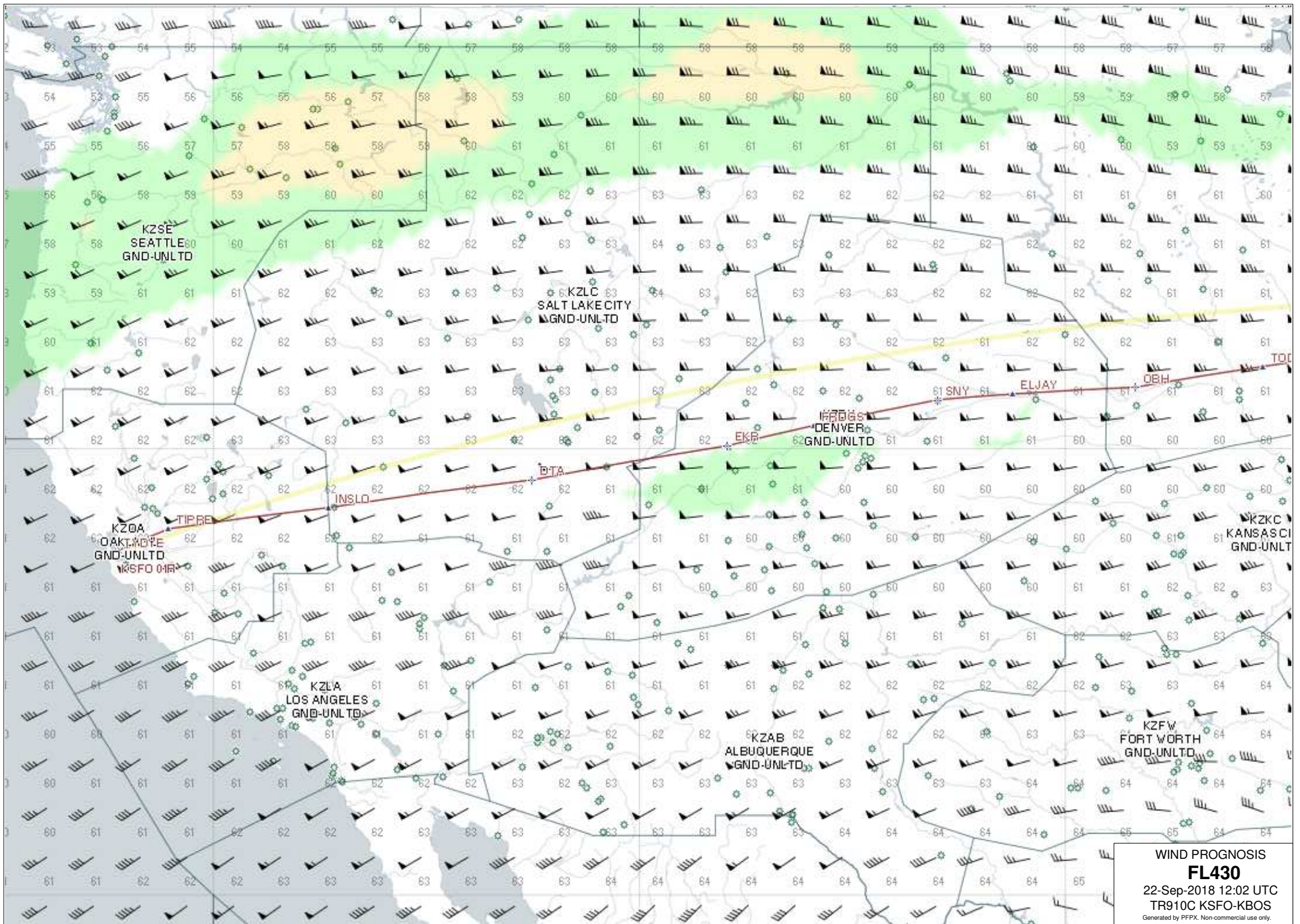

WIND PROGNOSIS

FL430

22-Sep-2018 12:02 UTC

TR910C KSFO-KBOS

Generated by PFPX. Non-commercial use only.

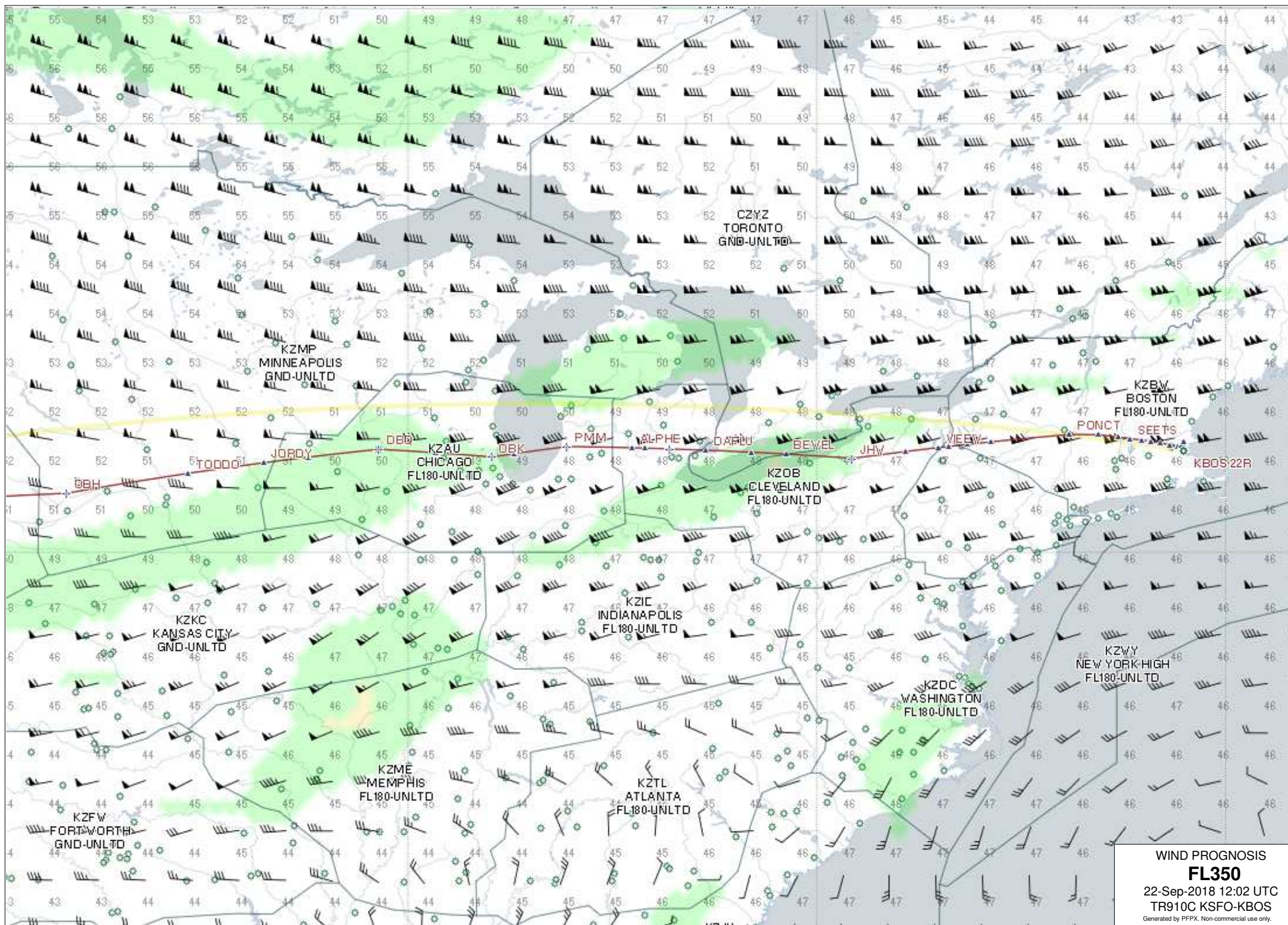

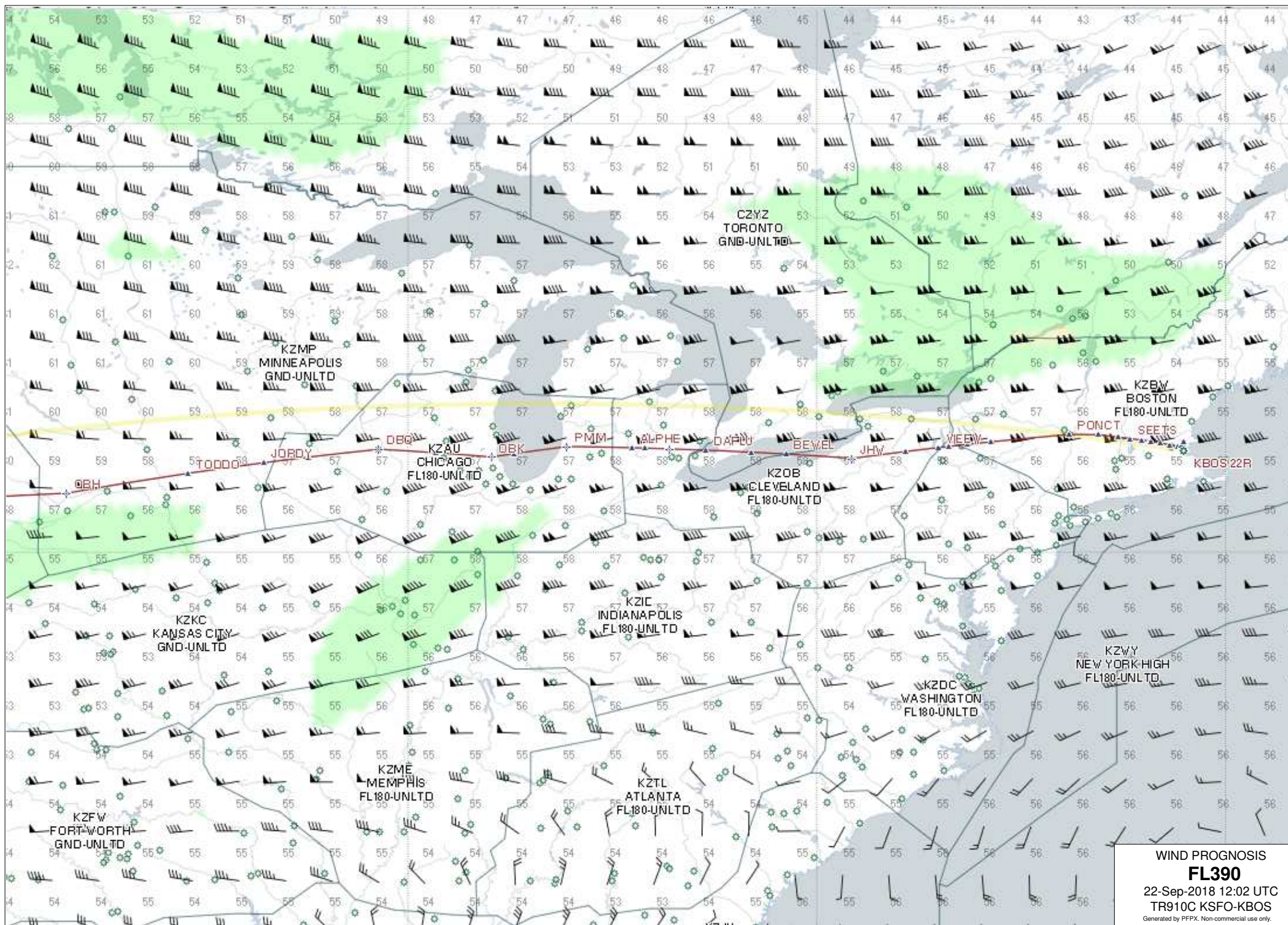

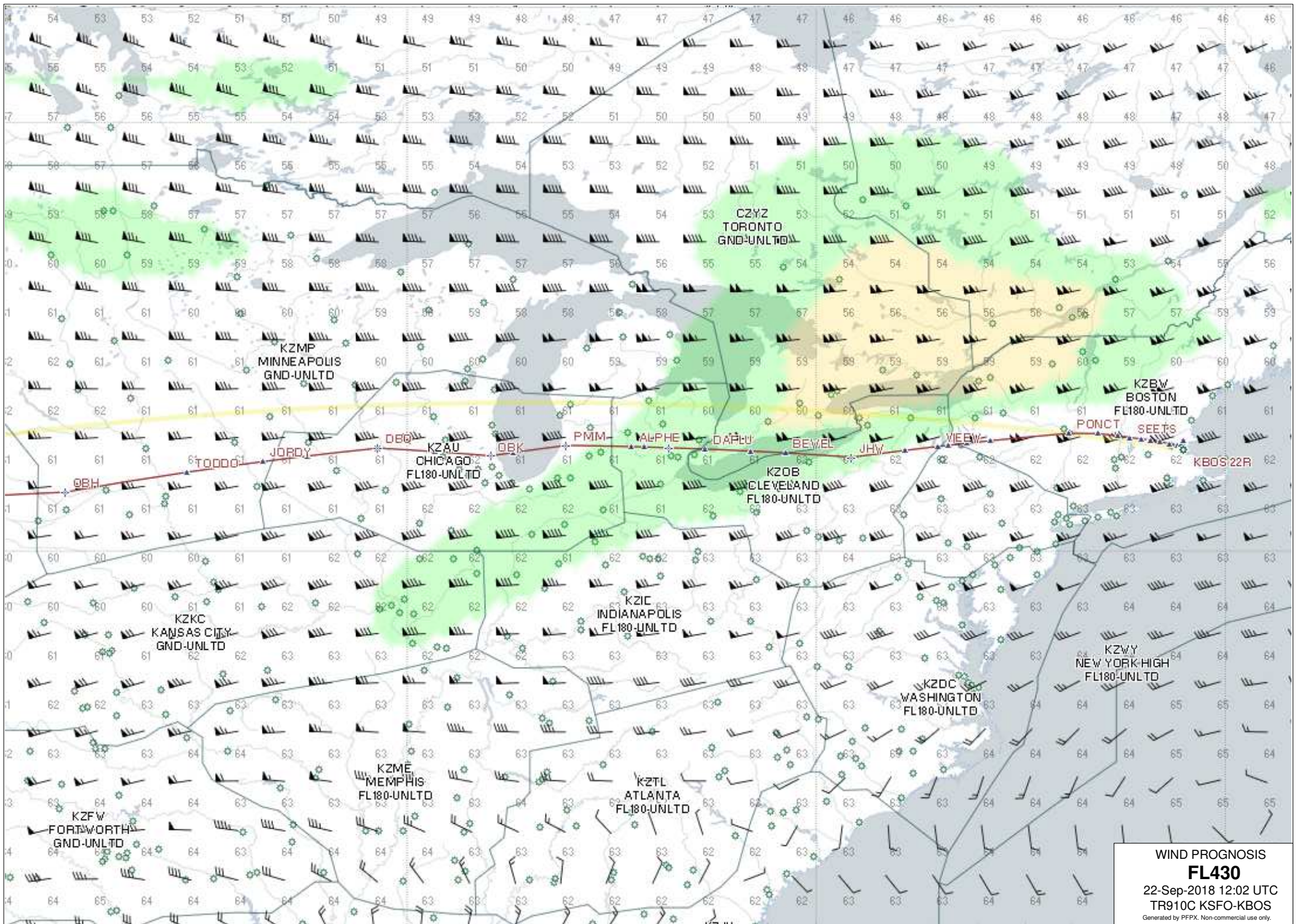

WIND PROGNOSIS
FL430
 22-Sep-2018 12:02 UTC
 TR910C KSFO-KBOS
Generated by PFPX. Non-commercial use only.